

## IMPORTANT MESSAGE FOR CYCLISTS USING AIRPORT DRIVE

2010

As a result of construction and changes to the airport road network, and in the interests of safety, cycling on Airport Drive, between Charlie Earp Bridge and the International Terminal roundabout is prohibited until further notice from BAC.

Cycling is also prohibited on new roads at the airport, including Moreton Drive and Nancy-Bird Way.

Understanding that cyclists travelling to and from work at the airport may not have alternative forms of transport available, BAC has designated a cycling route via Charlie Earp Bridge, Lakeside Drive and Qantas Drive that is outlined on the map located below. The route is clearly signposted.

In the future BAC will progressively construct additional cycle paths once access to off-airport facilities becomes available.

**It is essential that cyclists follow the designated route. Details of the route are shown in maps below.**

MAP 1 – DESIGNATED CYCLE ROUTE BETWEEN LAKESIDE DRIVE AND QANTAS DRIVE

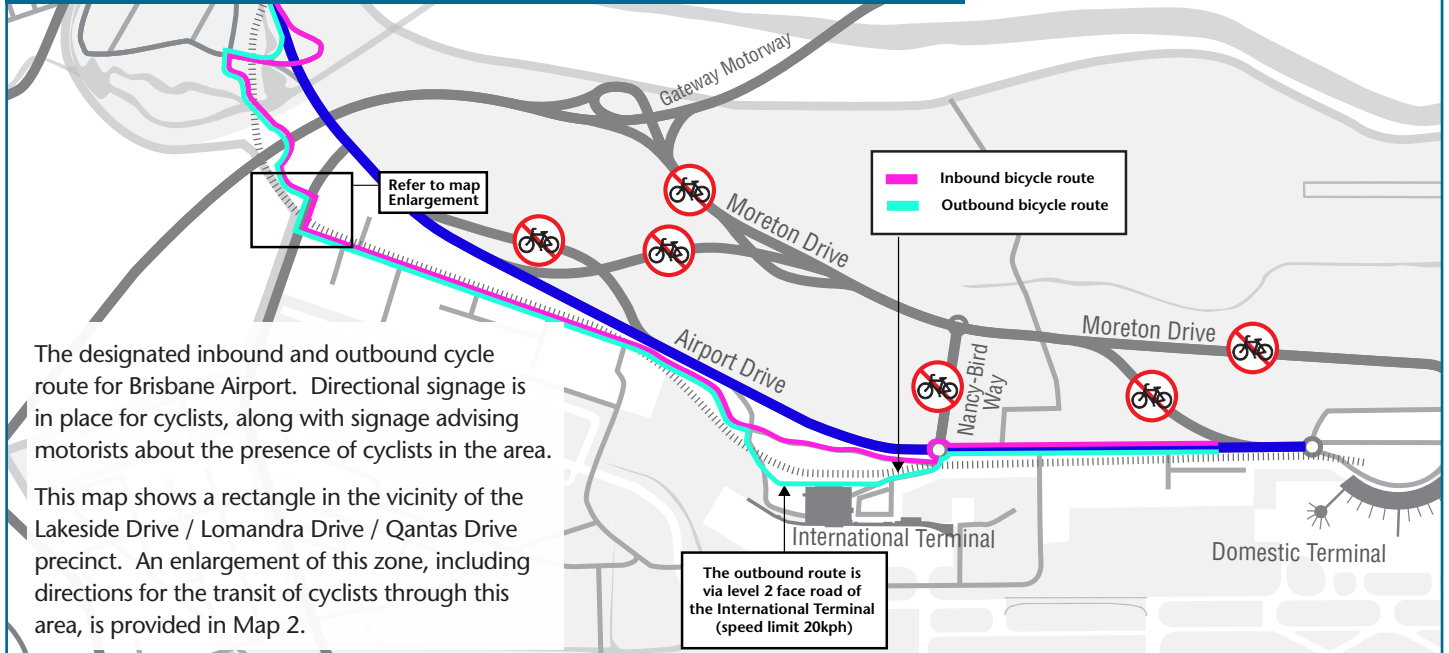

MAP 2 – DESIGNATED CYCLE ROUTE BETWEEN LAKESIDE DRIVE AND QANTAS DRIVE

