

KEYPLAN

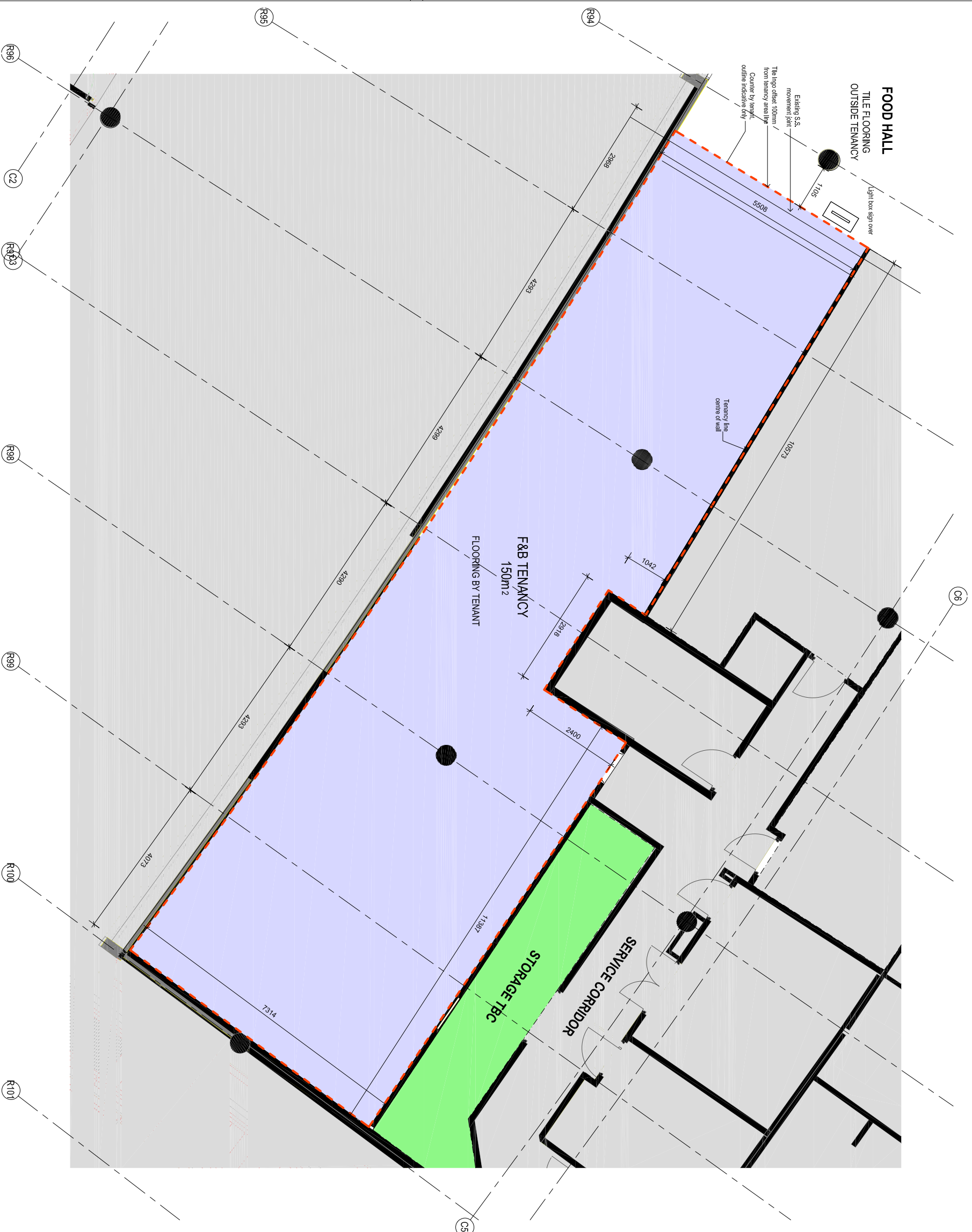
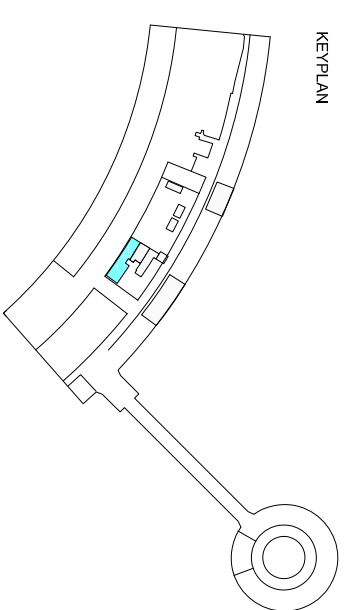

1 2H-15 - FLOOR PLAN
1:50 @ A1
1:100 @ A3

THIS PLAN IS ISSUED IN ACCORDANCE WITH, AND FORMS PART OF, THE RFP. ALL TERMS AND CONDITIONS OF THE RFP APPLY TO THIS PLAN. THIS PLAN IS MADE AVAILABLE ON A STRICTLY NON-RELIANCE BASIS AND MAY NOT BE RELIED UPON BY ANY PERSON

NOTES

1. THIS PLAN IS CURRENT AS PER THE REVISION DATE AND IS INDICATIVE ONLY. THE LESSOR AND ITS AGENTS RESERVE THE RIGHT TO CHANGE THIS INDICATIVE PLAN AT ANY TIME IN THEIR ABSOLUTE DISCRETION INCLUDING BUT NOT LIMITED TO THE FOLLOWING ELEMENTS:
 - COLUMN SIZES & LOCATIONS
 - PRR LOCATIONS
 - ROP & EXTEND OF REAR ZONE
 - OVERHEAD BEAM LOCATIONS INCLUDING BUT NOT LIMITED TO ELECTRICAL DISTRIBUTIONBOARDS, MECHANICAL CONTROL BOXES, COMMUNICATION BOXES & HYDRAULIC WATER POINTS, LOCATION OF DRAINAGE POINTS, SHOPFRONT PER LOCATIONS, OVERHEAD BEAM LOCATION DETAILS AND MATERIAL DETAILS
2. BEFORE COMMENCING SHOP DESIGN/FITOUT YOU SHOULD ENSURE THAT YOU HAVE THE MOST UP TO DATE INFORMATION ABOUT THE PREMISES & FINAL LEASE OUTLINE DRAWING FOR THIS TENANCY.
3. THE LESSOR, ON ITS OWN BEHALF & ON BEHALF OF ITS AGENTS, DISCLAIMS ANY LIABILITY & RESPONSIBILITY FOR ANY COST, LOSS, DAMAGE OR CLAIM OF WHATEVER NATURE OR KIND (INCLUDING NEGLIGENCE) SUFFERED OR SUSTAINED OR INCURRED BY ANY PERSON, CORPORATION OR OTHER LEGAL ENTITY WHICH ARISES OUT OF OR ALLEGED RELIANCE ON THIS INDICATIVE PLAN.
- 4.

ABBREVIATIONS

COL	COLUMN
C.O.S	CHECK ON SITE
EX	EXISTING
FDS	FLIGHT INFORMATION DISPLAY SCREEN
TBC	TO BE CONFIRMED

LEGEND

- OUT OF SCOPE
- TENANCY LINE
- BUILT FORM ZONE

COPYRIGHT OF THIS DRAWING IS THE PROPERTY OF BRISBANE AIRPORT CORPORATION. THE INFORMATION CONTAINED HEREIN IS UNCLASSIFIED AND NOT FOR DISTRIBUTION OUTSIDE THE AIRPORT OPERATIONS. THE REVISIONS OF THIS DRAWING SHALL BE INDICATED BY A NUMBER IN THE REVISIONS COLUMN. THE DESIGNING CONSULTANT SHALL BE RESPONSIBLE FOR THE DESIGN AND THE CONSULTANT SHALL BE RESPONSIBLE FOR THE DESIGN AND THE CONSULTANT SHALL BE RESPONSIBLE FOR THE DESIGN.	
DESIGNER: ER CHECKED: AS DATE: 20/1/23 REV: 1	PROJECT: DTB SOUTHERN RETAIL UPGRADE DRAWING: 2H-15 - Floor Plan SCALE: AS INDICATED SHEET: A1 REVISION: 2
BRISBANE AIRPORT CORPORATION BRISBANE AIRPORT BRISBANE AIRPORT CENTRAL PO BOX 1, MAIN TOWN CENTRAL BRISBANE QLD 4008 PH: +61 7 552 3000 FAX: +61 7 552 3114 WWW.BRISBANEAIRPORT.COM.AU	
DTB SOUTHERN RETAIL UPGRADE PROJECT NO: 1220004 / 1 / 06 / 6801	

1:50 @ A1
1:100 @ A3

ORIG	DATE	REV	AMENDMENTS
ER	20/01/23	1	
ER	16/01/23	2	

studiospillane
STUDIOSPILLANE INTERIOR DESIGN
www.studiospillane.com.au

CUSHWAY
BLACKFORD
CONSULTING ENGINEERS

Design Coordinated	Checked	AS
ER	AS	AS
AL	AS	AS

DRAFT ISSUE

BRISBANE AIRPORT CORPORATION
BRISBANE AIRPORT
BRISBANE AIRPORT CENTRAL
PO BOX 1, MAIN TOWN CENTRAL
BRISBANE QLD 4008
PH: +61 7 552 3000
FAX: +61 7 552 3114
WWW.BRISBANEAIRPORT.COM.AU