

BAG HAS ENTERED INTO A LICENCE AGREEMENT WITH NEARMAP PTY LTD TO USE CERTAIN MAPS OF THE AIRPORT TO PRODUCE THIS PRODUCT UNDER THE FOLLOWING CONDITIONS:  
1. YOU MAY ONLY USE, COPY OR DISTRIBUTE THE PRODUCT FOR BAG INTERNAL BUSINESS PURPOSES.  
2. YOU UNDERTAKE TO DESTROY OR RETURN TO BAG ANY AND ALL COPIES OF THE PRODUCT WHICH ARE WITHIN YOUR POSSESSION, CUSTODY OR CONTROL, WHEN YOU NO LONGER REQUIRE THEM FOR BAG INTERNAL BUSINESS PURPOSES.

ALL DIMENSIONS ARE IN METRIC SYSTEM. FOR THE SAKE OF CLARITY, SOME UNDERGROUND SERVICES MAY BE DEPICTED AS SINGLE LINES AND UNLESS OTHERWISE STATED, ALL DIMENSIONS ARE TO FACE UNLESS OTHERWISE STATED.  
VALUES OF PSM 31 LOCATED NEAR THE INTERSECTION OF THE RUNWAYS AT THE OLD AIRPORT ARE TO BE USED FOR THE OLD AIRPORT.  
SUBTRACT 1.5% FROM AERODROME ALL DRAWINGS PRODUCED BY BAG IN MICROSTATION DGN FORMAT. THEREFORE NO WARRANTIES ARE MADE FOR DIFFERENCES BETWEEN THE DIMENSIONS SHOWN ON THESE DRAWINGS AND THE DIMENSIONS ON WITHOUT THE NECESSARY MICROSTATION RESOURCE FILES.

THIS PLAN CARRIES BRISBANE AIRPORT CORPORATION PTY. LTD. (BAC) COPYRIGHT AND IS SUPPLIED FOR INFORMATION ONLY. THIS PLAN MUST BE VERIFIED FOR ACCURACY AND COMPLETENESS BY NECESSARY INVESTIGATION, SITE INSPECTION AND MEASUREMENT. THE INFORMATION CONTAINED ON THIS PLAN AND ANY ASSOCIATED DISCUSSIONS, THE PLAN REMAINS PRELIMINARY IN STATUS UNLESS ALL SIGNATURES HAVE BEEN APPENDED. DO NOT SCALE DRAWING. USE FIGURED DIMENSIONS ONLY.

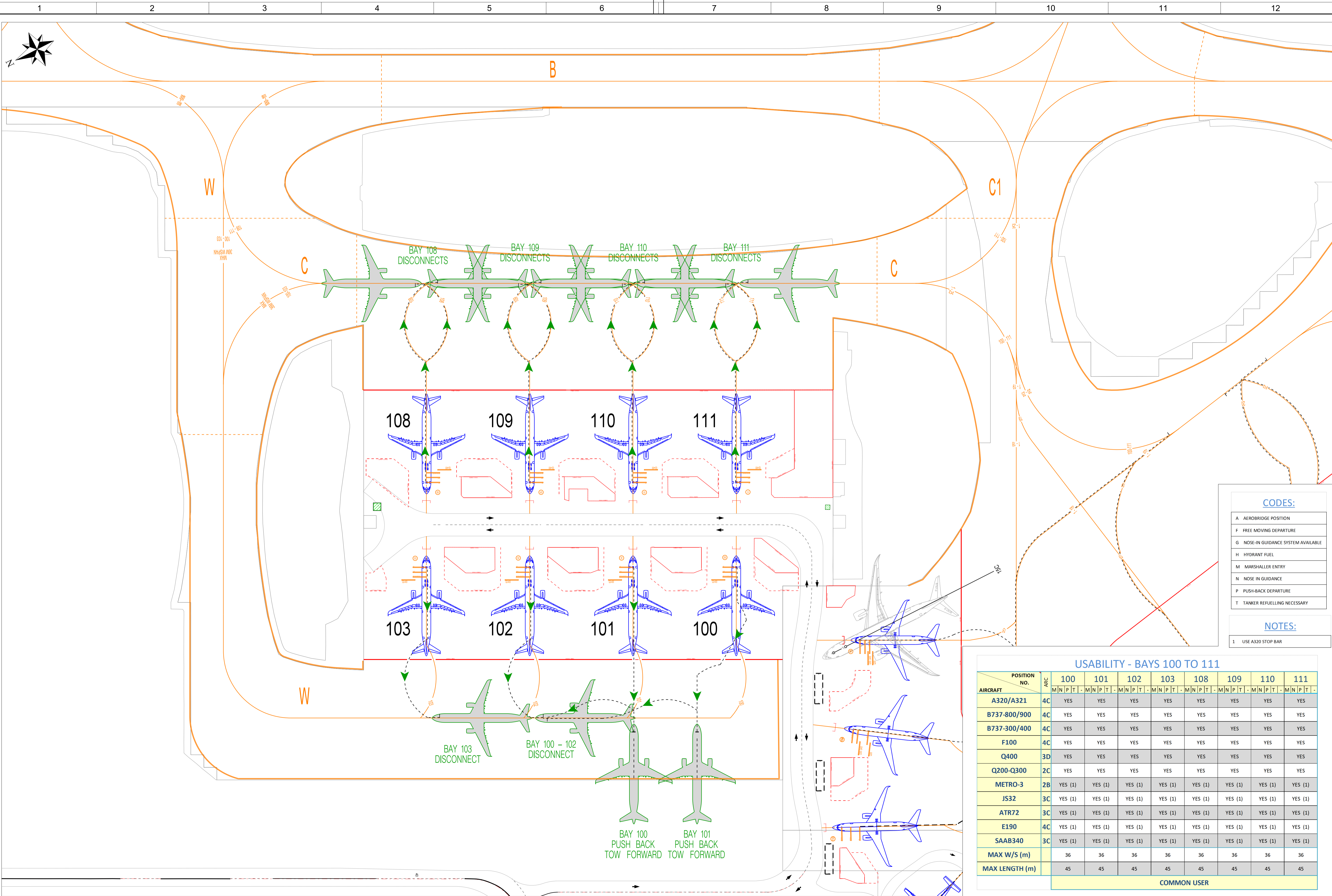

**CODES:**

- A AEROBRIDGE POSITION
- F FREE MOVING DEPARTURE
- G NOSE-IN GUIDANCE SYSTEM AVAILABLE
- H HYDRANT FUEL
- M MARSHALLER ENTRY
- N NOSE IN GUIDANCE
- P PUSH-BACK DEPARTURE
- T TANKER REFUELLING NECESSARY

**NOTES:**

- USE A320 STOP BAR

**USABILITY - BAYS 100 TO 111**

AIRCRAFT	POSITION NO.	ARC	100		101		102		103		108		109		110		111		
			M	N	P	T	M	N	P	T	M	N	P	T	M	N	P	T	M
A320/A321	4C		YES	YES	YES	YES	YES	YES	YES	YES	YES	YES	YES	YES	YES	YES	YES	YES	
B737-800/900	4C		YES	YES	YES	YES	YES	YES	YES	YES	YES	YES	YES	YES	YES	YES	YES		
B737-300/400	4C		YES	YES	YES	YES	YES	YES	YES	YES	YES	YES	YES	YES	YES	YES	YES		
F100	4C		YES	YES	YES	YES	YES	YES	YES	YES	YES	YES	YES	YES	YES	YES	YES		
Q400	3D		YES	YES	YES	YES	YES	YES	YES	YES	YES	YES	YES	YES	YES	YES	YES		
Q200-Q300	2C		YES	YES	YES	YES	YES	YES	YES	YES	YES	YES	YES	YES	YES	YES	YES		
METRO-3	2B		YES (1)	YES (1)	YES (1)	YES (1)	YES (1)	YES (1)	YES (1)	YES (1)	YES (1)	YES (1)	YES (1)	YES (1)	YES (1)	YES (1)	YES (1)		
JS32	3C		YES (1)	YES (1)	YES (1)	YES (1)	YES (1)	YES (1)	YES (1)	YES (1)	YES (1)	YES (1)	YES (1)	YES (1)	YES (1)	YES (1)	YES (1)		
ATR72	3C		YES (1)	YES (1)	YES (1)	YES (1)	YES (1)	YES (1)	YES (1)	YES (1)	YES (1)	YES (1)	YES (1)	YES (1)	YES (1)	YES (1)	YES (1)		
E190	4C		YES (1)	YES (1)	YES (1)	YES (1)	YES (1)	YES (1)	YES (1)	YES (1)	YES (1)	YES (1)	YES (1)	YES (1)	YES (1)	YES (1)	YES (1)		
SAAB340	3C		YES (1)	YES (1)	YES (1)	YES (1)	YES (1)	YES (1)	YES (1)	YES (1)	YES (1)	YES (1)	YES (1)	YES (1)	YES (1)	YES (1)	YES (1)		
MAX W/S (m)			36	36	36	36	36	36	36	36	36	36	36	36	36	36	36		
MAX LENGTH (m)			45	45	45	45	45	45	45	45	45	45	45	45	45	45	45		

**COMMON USER**

SCALE 0 15 30 45 METRES  
1:750

151037	A.H	MAX W/S AND LENGTH ADDED	30/08/18	2			
151037	A.H	FIRST ISSUE SUPERCEDE OPR1215170220001	08/11/16	1			
Req. No.	Drawn	Amendment	Date	Rev. No.	Checked By	Date	

Authorised Rep. & Signature  
STEPHENE GOODWIN  
GENERAL MANAGER OPERATIONS  
Authorised Rep. & Signature  
CHRIS YOUNG  
AIRSIDE STANDARDS MANAGER  
Checked By

Date  
25/11/16  
Date  
25/11/16  
Date

BRISBANE AIRPORT  
DTB APRON USABILITY  
NORTHERN APRON

**BRISBANE AIRPORT AUSTRALIA**

Brisbane Airport Corporation Pty Ltd  
11 The Circuit Brisbane Airport QLD 4008  
PO Box 61 HamBlox QLD 4007 Australia  
Telephone: +61 7 3406 3000  
Facsimile: +61 7 3406 3111  
Email: info@bac.com.au  
www.brisbaneairport.com.au  
ABN 54 076 870 850

Scale 1:750  
Size A1  
Revision 2

Design Ref. / Project Ref. / Discipline / Airport Precinct / Sub-Number  
Drg. No. OPR / 151037 / O / 22 / 0023

Plot Date & Time: 3/09/2018 3:40:06 PM